

Instructions for preparing an ACU-Drop II sample

Sampling with Dropper Tip

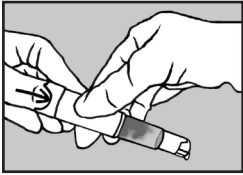

Press the button on the bottom firmly until it is completely pushed in and level with the indentation.

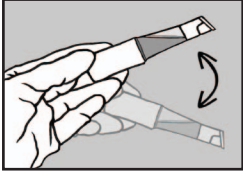

Gently rock and swirl at least 5 times to mix the liquids completely.
Your sample is now ready to use.

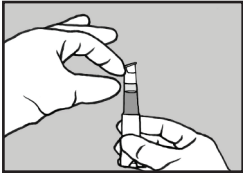

Hold the ACU-Drop II in a vertical position and flick the cap to make sure that no liquid remains inside the dropper tip.

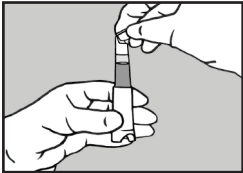

Open the flip cap very carefully by lifting the cap just a little bit to release the pressure.
-Only with first time use-

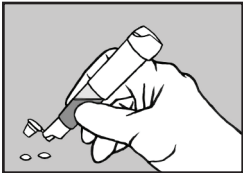

The first 2 drops should be dispensed and discarded.
-Only with first time use-



The ACU-Drop II is now ready to use to apply a sample drop for testing.

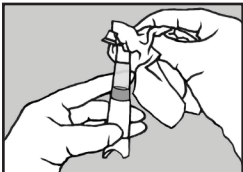

After each use, be sure to wipe the dropper tip and inside of cap to keep them clean.

Sampling with Syringe

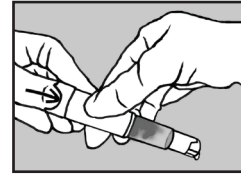

Press the button on the bottom firmly until it is completely pushed in and level with the indentation.

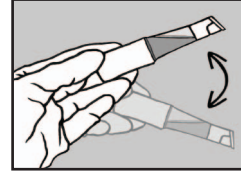

Gently rock and swirl at least 5 times to mix the liquids completely.
Your sample is now ready to use.

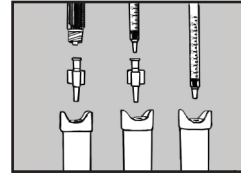

For luer lock syringe, you must twist the adaptor onto the tip of the syringe. For standard syringe, use of the adaptor is optional.

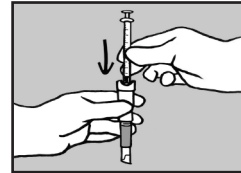

Turn the ACU-Drop II upside down and push the luer tip of the syringe or adaptor firmly into the luer fitting on the bottom of the ACU-Drop II.

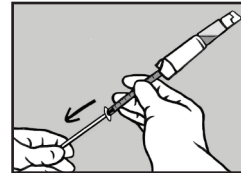

Turn the ACU-Drop II right-side up and, using both hands on the syringe, withdraw the contents.

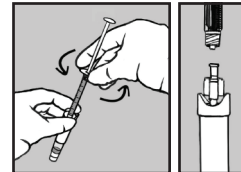

If using adaptor, carefully unscrew the syringe from the adaptor, leaving the adaptor in the bottom of the ACU-Drop II. For standard syringe with no adaptor, release the syringe from the luer fitting by putting your finger on the bottom at the indentation and twist the syringe to disconnect.



Seal the adapter with screw cap to discard or re-use the ACU-Drop II. Possibility for re-use depends on the shelf-life of the product after reconstitution.

Use the syringe to deliver your sample.